

3in1 Microcurrent & Hot & Cool System



Deliver Deeper. Heal Faster

D °COOL

3in1 Microcurrent & Hot & Cool System



Electroporation

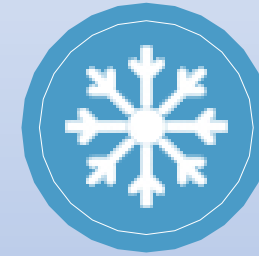

Cold treatment
(-15°C~0°C)



Heat treatment
(0°C~40°C)

Microcurrent Technique

Electromesotherapy or **Electroporation** is the latest major innovation in professional cosmetology. Micro-currents enable a high concentration of active ingredients - up to 80% more - to penetrate to the very heart of the skin, exerting far-reaching beneficial effects.

Electroporation uses weak electrical impulses to create temporary channels in the skin. Temporarily, the permeability of cell membranes increases considerably, enabling deep penetration of active ingredients. When the pulse stops, the cells return to their original structure.

Electromesotherapy coupled with specific blends of Peptides, Collagen, Vitamins and Hyaluronic Acid stimulates fibroblasts to produce more collagen and elastin, resulting in brighter, firmer skin with fewer wrinkles and imperfections.

After several treatments, significant improvements appear, with multiple rejuvenating effects. The skin becomes fresh, radiant and firm, and its cellular metabolism and hydration are restored.

Electromesotherapy or **Electroporation** is a major innovation in professional cosmetology. It allows optimal penetration of the active ingredients with a real effect on the skin.

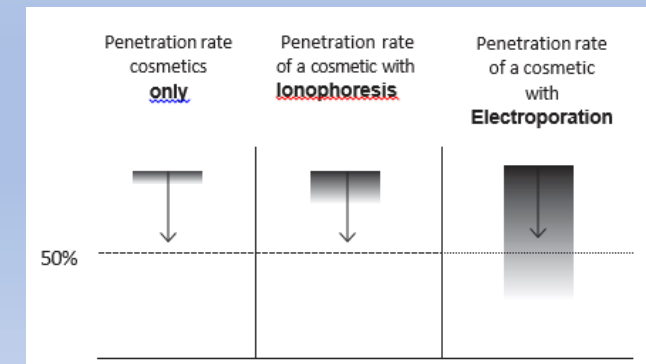
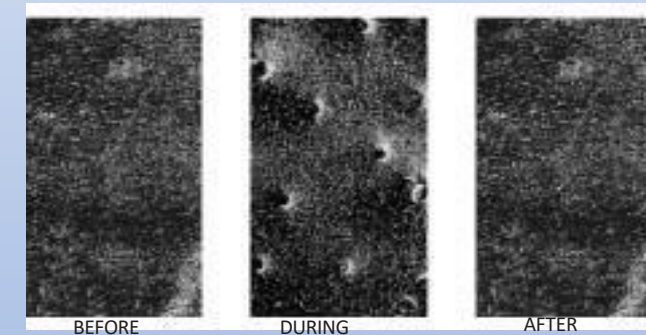
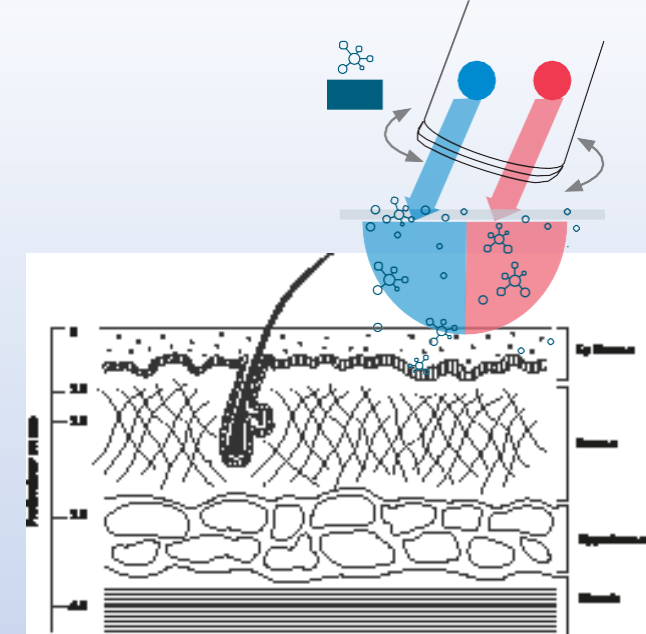

Contents

1. Overview

2. Main Applications

3. Presentation of the Device

4. Three Main Functional Systems

5. Advantages

6. Instructions

7. Operation

8. Maintenance

1. Overview

D-COOL offers three powerful functions and is widely used in the “DNA Cell Injection” treatment popularized in Korean medical aesthetics. With over 20,000 units already in use, D-COOL enables simultaneous COOL-based therapy and active essence infusion. It boosts product absorption by skin cells up to 80%, with a penetration rate more than 20 times higher than conventional methods.

2. Main Applications

- 1) Deep product absorption
- 2) Boosts cell activity
- 3) Stimulates collagen
- 4) Reduces fine lines
- 5) Firms and lifts skin
- 6) Improves lymph flow
- 7) Tightens pores
- 8) Brightens skin tone
- 9) Reduces eye bags & dark circles
- 10) Speeds up skin repair

3. Presentation of the Device



Handle



Conductive Patch



Conductive Patch Cable



Power Cable



Power Adapter



Inlet Hose

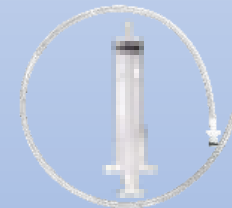

Drain Hose with Syringe

4. Three Main Functional Systems

Electroporation

+

Cold Treatment
(-15°C~0°C)

+

Heat Treatment
(0°C~40°C)

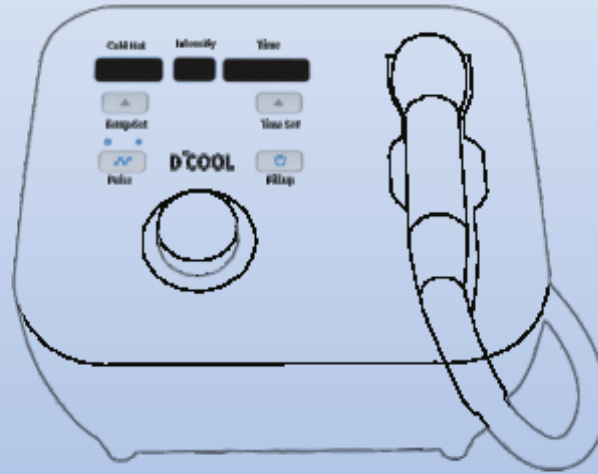

D-COOL is a multi-functional device that integrates electroporation, cold therapy and heat therapy. Heat therapy opens pores and relaxes muscles; Cold treatments help to calm the skin, reduce skin temperature, tighten pores opened by laser treatment, electroporation allows for higher solution permeability.



The Key Characteristics

- 1) Needle-free therapy (non-invasive)
- 2) Does not destroy the skin surface and skin cell organization
- 3) Efficient solution permeability

How does Microcurrent Work?

Microcurrent is an effective percutaneous drug delivery system. When using electroporation, D-Cool is able to instantaneously deliver electrical pulses to skin tissue, temporarily allowing faster and more efficient penetration through these pores.

Microcurrent use low-level electrical impulses—similar to the body's natural bioelectricity—to stimulate the muscles, cells, and tissues beneath the skin.

Key Mechanisms:

1. Muscle Stimulation
2. ATP Production Boost
3. Improved Product Absorption
4. Better Circulation and Lymphatic Flow

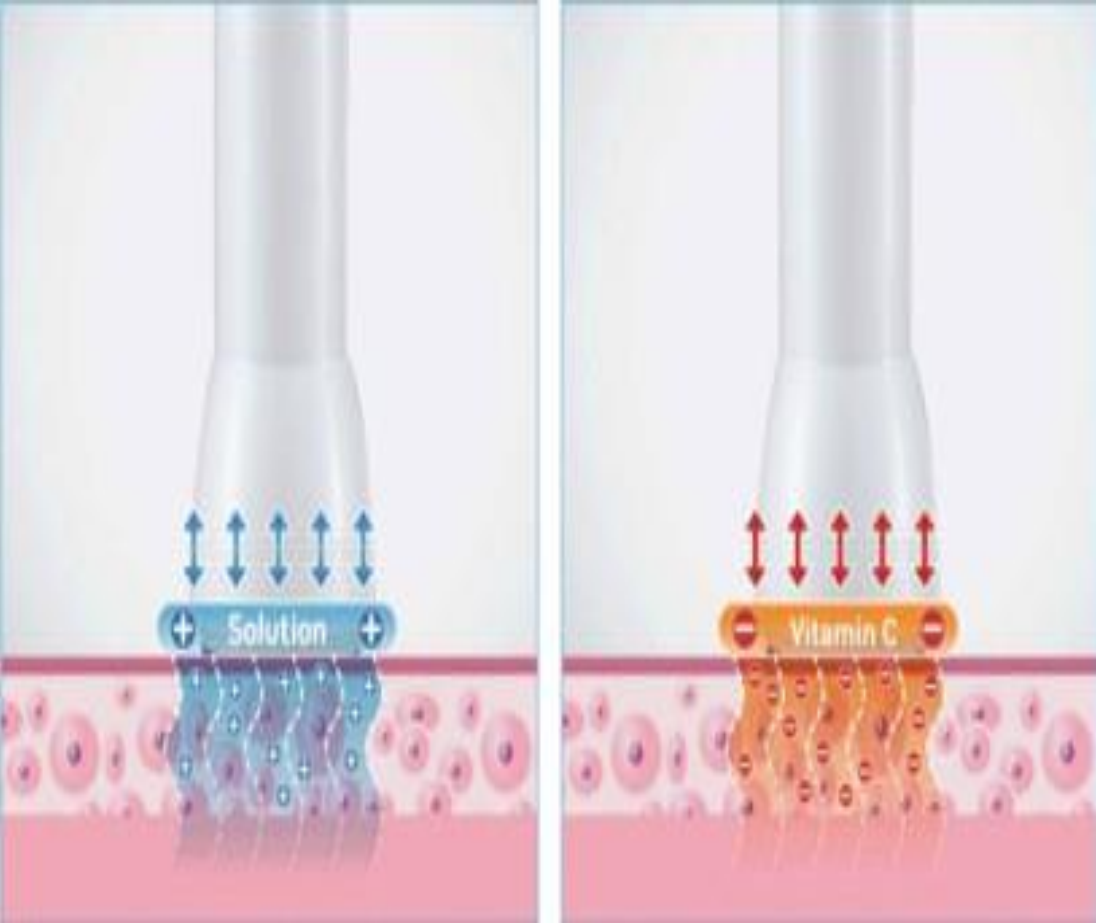

By adjusting the pulse polarity (+ or -), D-COOL effectively delivers different types of solutions into the skin:

- **Ordinary solutions** (e.g., Vitamin C products): Use Pulse (+) to enhance absorption into the dermis.
- **Other solutions** (with cooling): Use Pulse (-) for optimal infusion and cooling benefits.

5. Advantages

- 1) Advanced cold therapy and heat therapy function (cold treatment 0~-15°C/ heat treatment 0~40°C)
- 2) Electroporation with high permeability
- 3) Pulse mode (+) or (-) can be set according to the polarity of the solution.
- 4) Suitable for various types of solution introduction, ordinary solution with pulse +, dimension C products with pulse -
- 5) Reduce the postoperative slow down period and reduce the risk of pigmentation after inflammation
- 6) Compact & ergonomic handle design





Heat Treatment:

- 1) Thermocouple resistance can generate heat up to 40°C
- 2) Electroporation combined with the function of hyperthermia can complete electroporation under high temperature, and skin and muscle treatment can be in the most relaxed state, so as to better promote the osmosis and absorption of solution.



Cold Treatment:

- 1) The back-and-forth water circulation of the refrigerant can reduce the temperature of the TEC module to a minimum of -15°C , and can maintain low temperature for a long time.
- 2) Semiconductor components are cooled, and the electrode probes that contact the skin are also cooled.
- 3) -15°C strong cooling function can quickly cool the skin after laser, so as to calm the skin.
- 4) The cold treatment system can make the capillaries that dilate due to high temperature shrink sharply, reduce local congestion, so as to achieve the effect of redness and swelling. It can effectively shorten the downtime and reduce the risk of post-inflammatory pigmentation.

6. Instructions

Please follow the steps below to install your appliance correctly:

- 1) Open the package and check that it contains all the components listed. Remove the components from the package one by one and check that nothing is damaged.
- 2) Connect the treatment handle by inserting the cable into the socket provided on the appliance.
- 3) Connect the conductor clip to the device by inserting the cable into the socket provided.
- 4) Connect the power cable to the appliance by inserting it into the socket provided.
- 5) Connect the water inlet and outlet cables by inserting them into the sockets provided.
- 6) Press the Tem/Set key and then rotate the multifunction key to choose temperature from -15-40 degrees.
- 7) Press the multifunction key to start, when the machine is working the multifunction key will be flashing.
- 8) When the machine is working then rotate the multifunction key to set the RF EMS intensity.

7. Operation

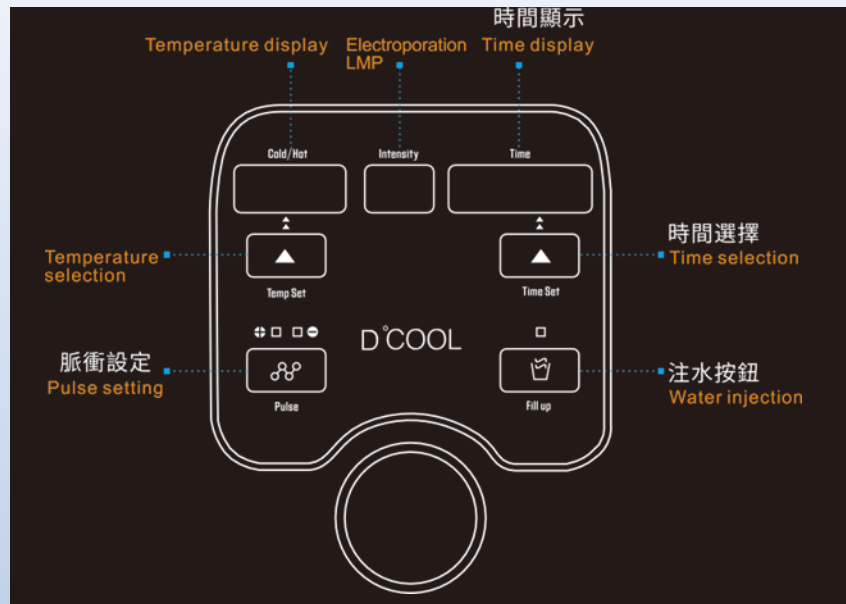

- 1) Press Time to select the treatment duration.
- 2) Then + to increase or - to reduce the treatment time.
- 3) Press Cold/Hot to select the temperature. Then + to increase or - to decrease the temperature.
(the temperature range is between -15 and 45°C, for cold use set the machine between -15 and 0° and for hot use between 40 and 45°C)
- 4) Press Intensity to select the electroporation intensity, the maximum being 50.
We recommend starting the session between 25 and 30 and then adjusting according to how the client feels.
- 5) Press Pulse - to put the machine into "Pulse" mode to deliver the chosen serum. If Pulse - is not activated, the machine will deliver a continuous flow of electrostimulation.
Once you have set and confirmed all the above parameters and applied the serum(s).
- 6) Press Start to start treatment.

Once you have completed the Pre-Care form, the following steps are recommended:

- [1] Disinfect the appliance with a disinfectant wipe, then plug it into the mains.
- [2] Carefully remove make-up with SOFT CLEAN milk and/or cleanse the skin with PURE FOAMER, to ensure that the skin is perfectly clean and disinfected.
- [3] Prepare the mixture of active ingredients: mix one or two depending on the indication to be treated, then apply to the area concerned with a brush.
- [4] Switch on the device (On/Off button on the back of the device), place the handle on the customer's face and press the START button.
and set the temperature (Cold/Hot) and intensity (Intensity).
- [5] Give the conductive clip to the client, who will hold it in her hand throughout the session.
- [6] Each zone requires between 6 and 8 passes.

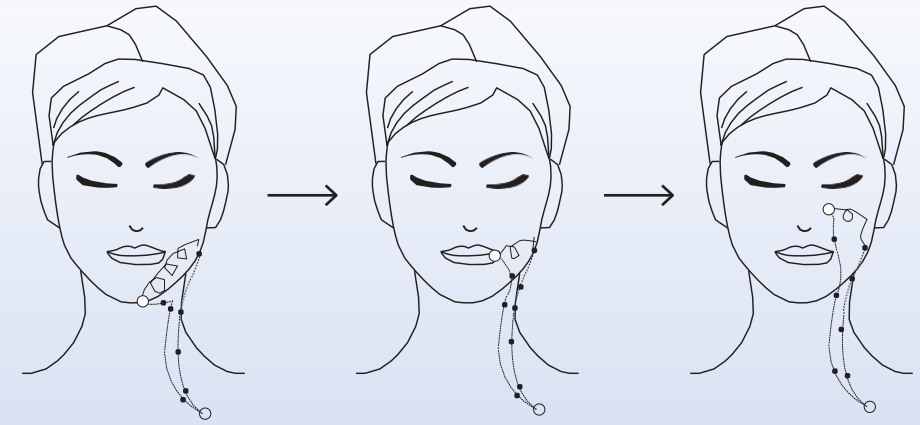

Redefining the oval of the face

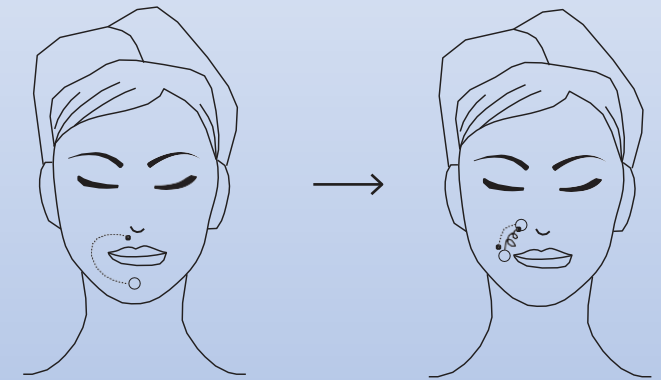

Work on the nasolabial fold

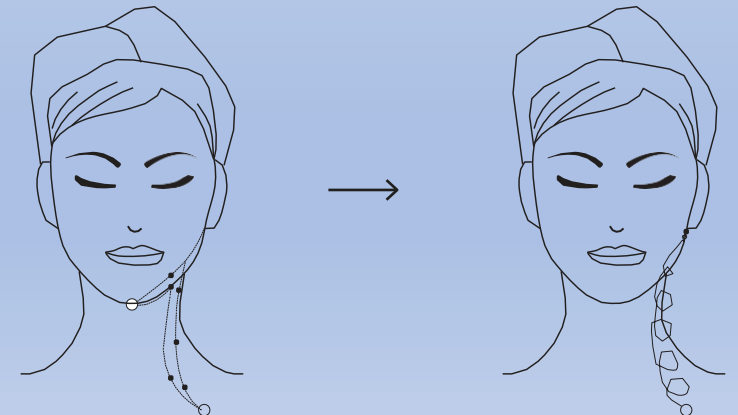

Neck wrinkles, double chin and drainage

8. Maintenance

- 1) As the handle and conductive clip are in contact with the customer's skin, they must be carefully cleaned after each treatment with 70° alcohol using cotton wool or a handkerchief.
- 2) To clean the junction between the handle and the treatment head, use 70° alcohol.
- 3) Change the water twice a month.
- 4) Do not use the appliance if the electrical voltage is unstable.
- 5) If the appliance's fuse is short-circuited due to unstable or excessive electrical voltage, use the spare fuse located at the power switch, replace the damaged fuse and resume use of the machine.
- 6) When the display shows WATER in the top right-hand corner, this means that the tank is empty, please fill it with water using the funnel supplied.

